

TANDEM TRAILER

MODEL 500

OWNER MANUAL



Manufactured by:
Country Manufacturing, Inc.
P.O. Box 104
Fredericktown, OH 43019
PH: 740-694-9926
FAX: 740-694-5088

I. INTRODUCTION

The Model 500 Tandem Axle Trailer is designed for rugged use and versatility. The sideboards are removable from any side allowing unloading from any of the four sides. By removing the four corner stakes the trailer can be converted into a flatbed. Two bed lengths (6 ft. and 7 ft) are available.

CAUTION

THIS TRAILER IS NOT FOR OVERHIGHWAY USE.

II. ASSEMBLY INSTRUCTIONS (Refer to Exploded View)

TOOLS REQUIRED

1/2" wrench
5/8" wrench
Pliers

CHASSIS ASSEMBLY (Refer to FIG. 1)

1. Connect wheel carrier (Item 2) to main chassis (Item 3) using the 3/4" shaft (Item 7). Insert the shaft through the holes in the carrier triangle uprights and the 1" square tube located on the chassis bottom. Secure with 3/4 washer and 1/8 cotter key.
2. Connect the tongue (Item 1) to the chassis using two 5/16 x 1 bolts, nuts, and lock washers (Item 10). Insert one bolt through the welded tab on the tongue and center hole of the chassis front cross member. Insert the second bolt through the holes at the rear top of the tongue and the center hole located on the angle cross member of the chassis. Tighten firmly.
3. Install the four wheels and secure with 3/4 washers and 1/8-cotter keys. Sealed Roller Bearing do not require grease.

ATTACHING BED TO CHASSIS

1. While holding bed (Item 11) between uprights on the chassis, align the pivot holes located at rear on the angle iron runners on the bottom side of the bed with the two holes on the uprights of the chassis. Once aligned, insert the 1/2" rod (Item 8) through the axle holder and bed holes allowing the bed to pivot. Install cotter pin through hole in 1/2" rod.
2. Install the four bed corner brackets by removing the four bolts located at each corner of the bed and reinserting through the holes of each bracket. Firmly secure using a 5/8" wrench.
3. Install the four 1 x 12 wood boards by inserting each into the slots of each corner stake. Install the two middle angle iron stakes into pockets located midway on the side rails while hooking the top over the sideboard.

III. MAINTENANCE

1. Sealed Roller Bearing do not require grease.
2. Periodically tighten all bolts and check for wear on all pivot joints. Replace as necessary.

FIG. 1

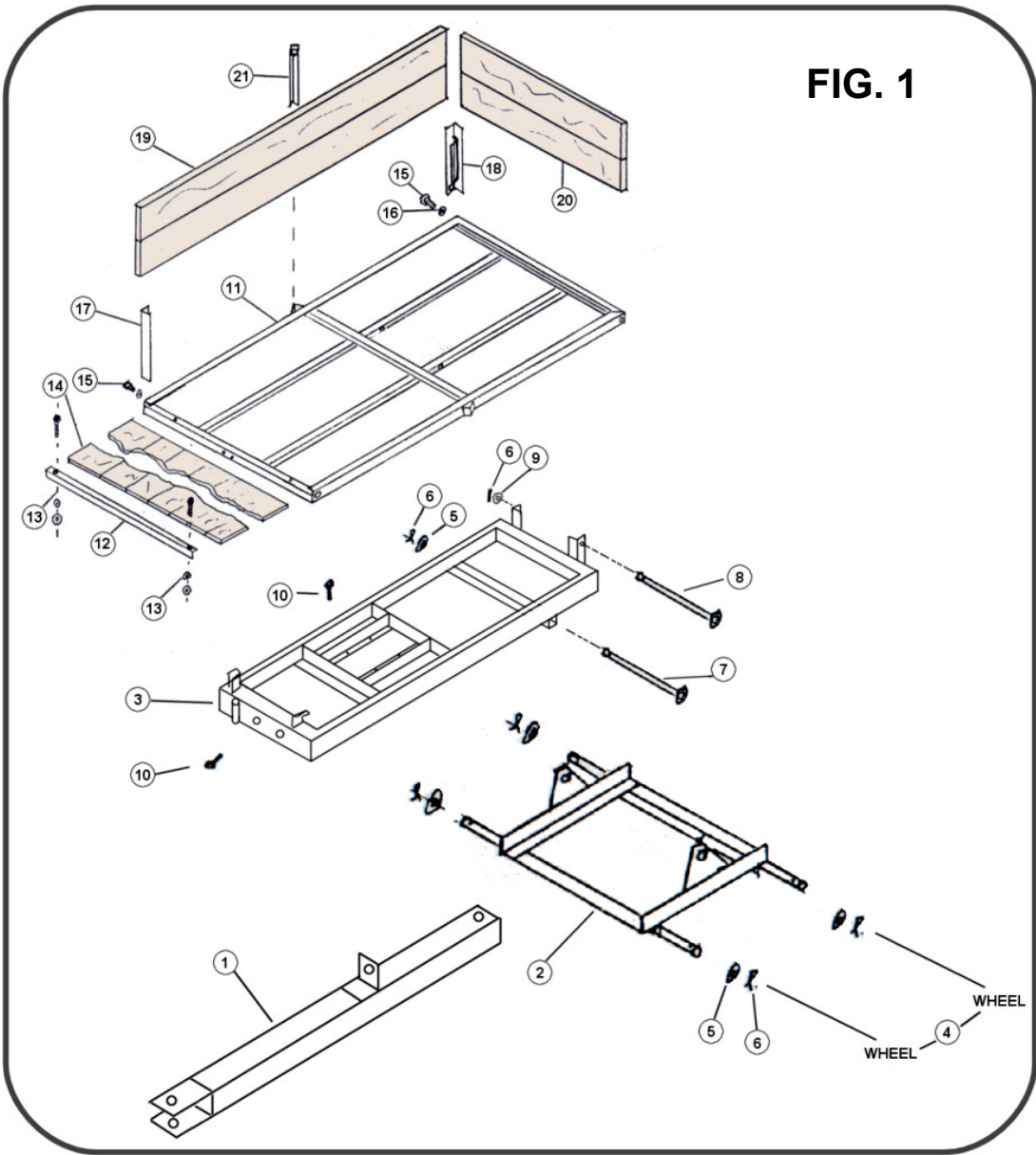

ITEM NO	DESCRIPTION	PART NO	QTY/UNIT
1	Tongue Assembly	5001	1
2	Wheel Carrier	5002	1
3	Chassis	5003	1
4	16-6.50 x 8 Wheel & Tire	5004	4
5	3/4 inch Flat Washer	5005	5
6	1/8 Cotter Key	5006	6
7	Wheel Carrier Shaft	5006	1
8	Bed Pivot Shaft	5008	1
9	1/2 inch Washer	5009	1
10	5/16 x 1 bolt/nut/washer	50010	2
11	Bed Frame	50011	1
12	Bed Frame Angle	50012	1
13	5/16 x 1 1/2 bolt/nut/washer	50013	2
14	Floor Board	50014	7
15	7/16 x 3/4 Bolt	50015	4
16	7/16 Washer	50016	4
17	Right Corner Bracket	50017	2
18	Left Corner Bracket	50018	2
19	Side Board	50019	2
20	End Board	50020	2
21	Side Stake	50021	2

WARRANTY POLICY

Country Manufacturing, Inc., will, at its option, replace or repair, without charge to the original purchaser any part or parts manufactured by it and found upon examination, to be DEFECTIVE IN MATERIAL AND/OR WORKMANSHIP if received for such examination within 90 days from date of original purchase.

Damage resulting from accident, abuse or neglect are conditions under which warranty cannot be claimed. Nor will warranty apply to damage resulting from failure to follow the Manufacturer's instruction for operation and maintenance nor from the improper selection of a particular application.

All transportation charges on, and damages and loss incurred in connection with the transportation of, parts submitted for replacement or repair under this WARRANTY shall be borne by the purchaser.

No other warranties, guarantees, or liabilities, either implied or expressed, will be the responsibility of Country Manufacturing, Inc.