

MODEL 3010 HYDRAULIC DUMP - ASSEMBLY INSTRUCTIONS

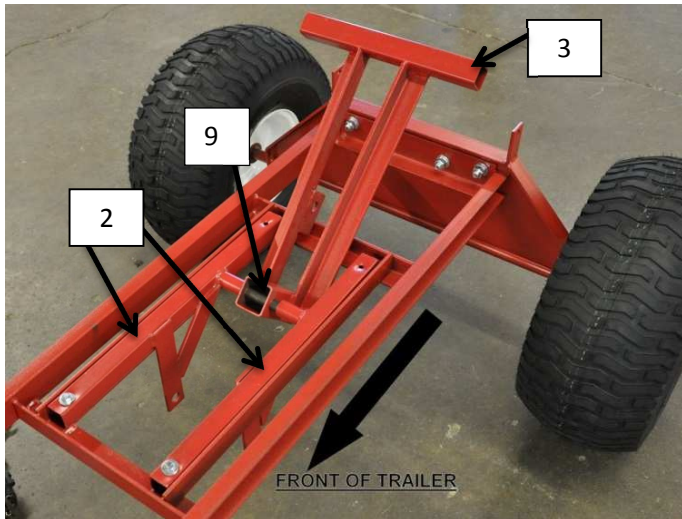

Assemble the jack frames(2), lift slide(3), and $\frac{3}{4}$ " x 6" pin(9) as shown in picture.

Align with the four holes provided on the chassis.

Insert 4 – $\frac{5}{16}$ " bolts / washers / nuts(12, 13, 14) and tighten.

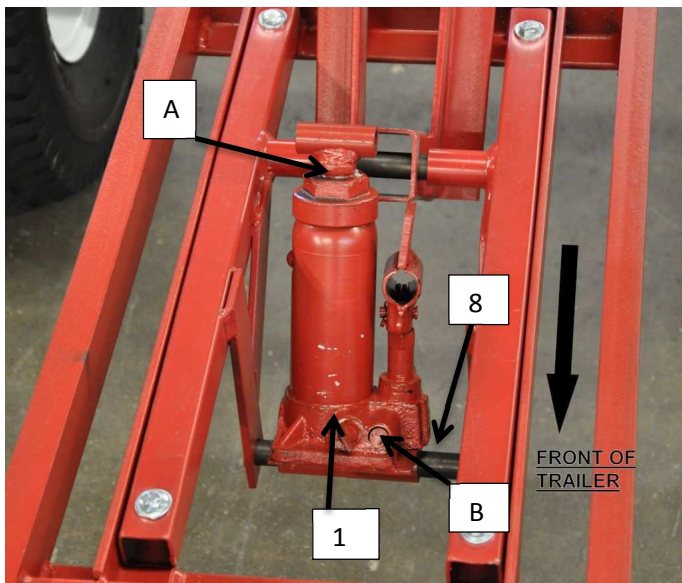

Insert jack(1) into the frame as shown in picture, using $\frac{3}{4}$ " x 7-1/2" pin(8).

Secure lower pin in position with cotter pin(16).

NOTE: Make sure jack cylinder is fully depressed(A) and release valve(B) is fully closed.

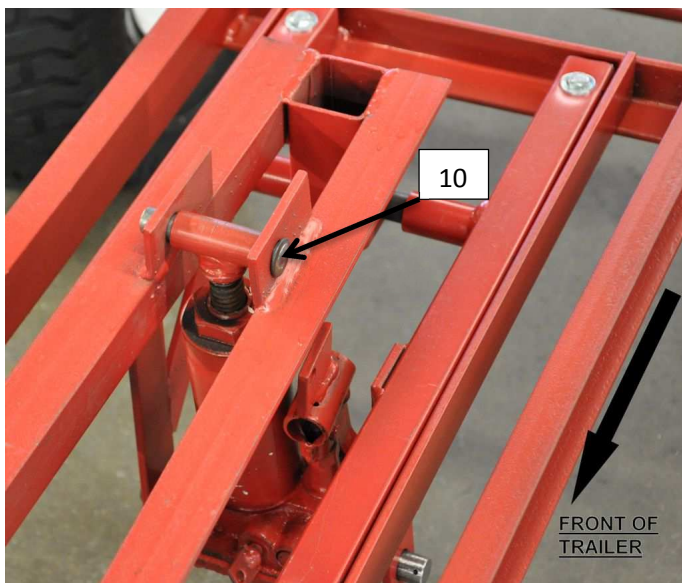

Swing slide into place over the jack, and pin in place using $\frac{1}{2}$ " x 3-5/8" pin(10).

NOTE: You will need to unscrew the top of the jack approximately 2 inches to align with the top hole in the slider.

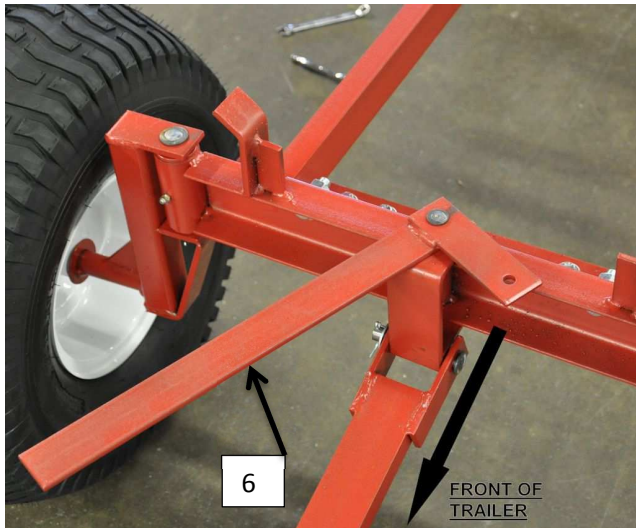

WAGONS ONLY (6300/7300/7340ATV)

Install the pump handle(6) by removing the wagon steering pivot pin.

Reinsert through the corner hole in the pump handle and resecure using same cotter pin.

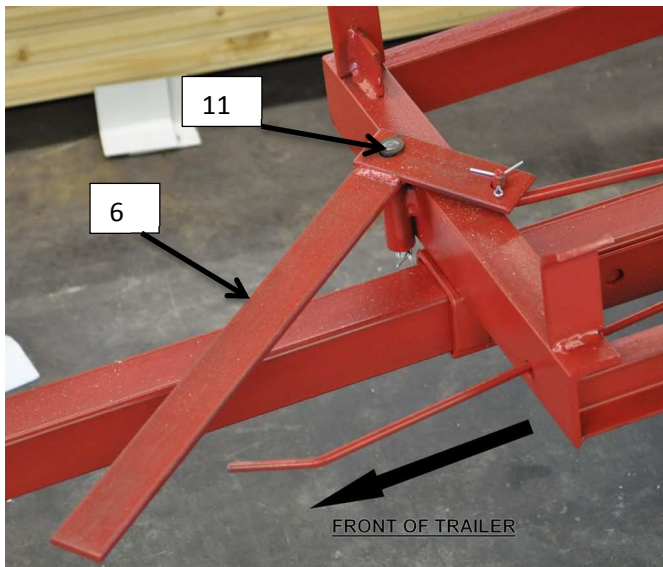

TRAILERS ONLY (6500/7500/7550ATV)

Install the pump handle(6) on the tandem chassis by inserting the pin(11) through the corner hole of the pump handle and through the welded bushing at the front of the chassis.

Secure pin using cotter pin(16).

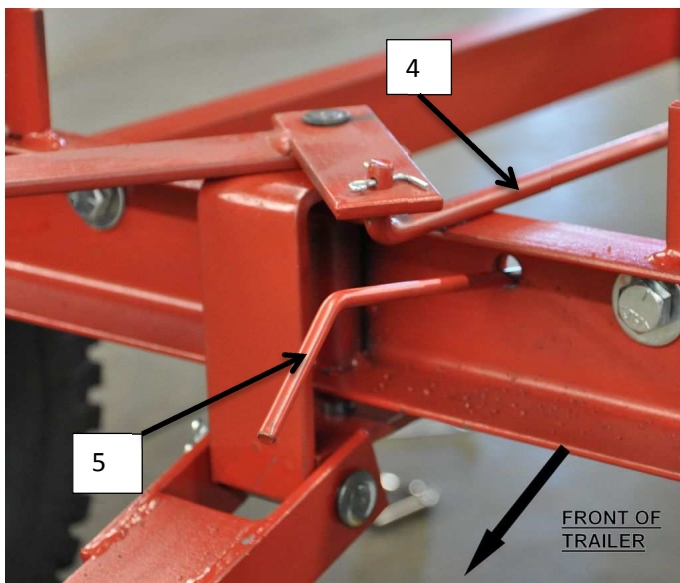

Insert the connecting rod(4) as shown and secure with cotter pin(16).

Insert the valve handle(5) through the small hole in the front of the chassis as shown.

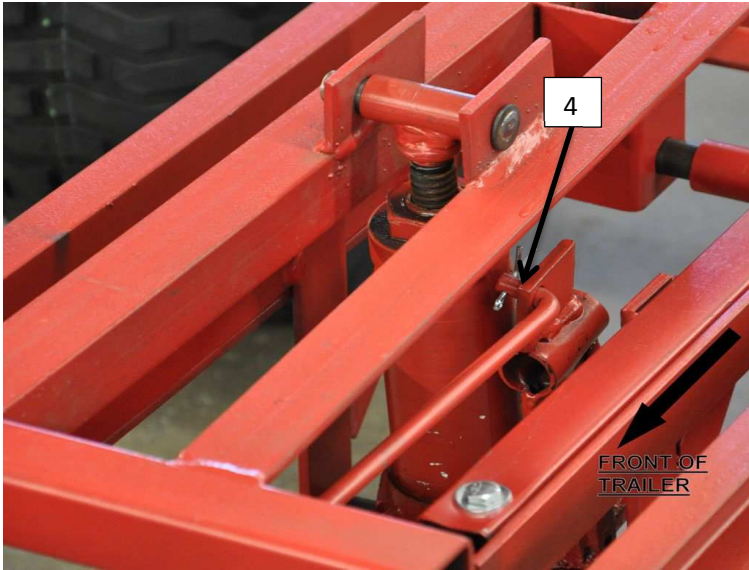

Insert the connecting rod(4) as shown into the hole on top of the jack valve and secure with cotter pin(16).



Insert the loop on the valve handle through the "U" clip(7).

Make sure the valve is completely closed. (Turn clockwise)

Bolt the "U" clip(7) in place through the pressure release valve at the bottom of the jack using the 1/4" x 3/4" bolt/nut(15).

NOTE: Tighten nut enough to secure onto bolt. Do not overtighten or it will cause the release handle to bind.



Pin bed onto frame with pin as instructed in trailer assembly.

You will need to adjust the slider so it rests against the bottom of the bed when the bed is in the down position.

You can adjust the height by removing the pin(10) and unscrewing the top of the jack to raise the slider position.

The slide needs to be right up against the bed when the jack is completely depressed to get the full dumping height.

Secure upper pin in position with cotter pin(16) when adjusted.

MODEL 3010 HYDRAULIC DUMP PARTS BREAKDOWN

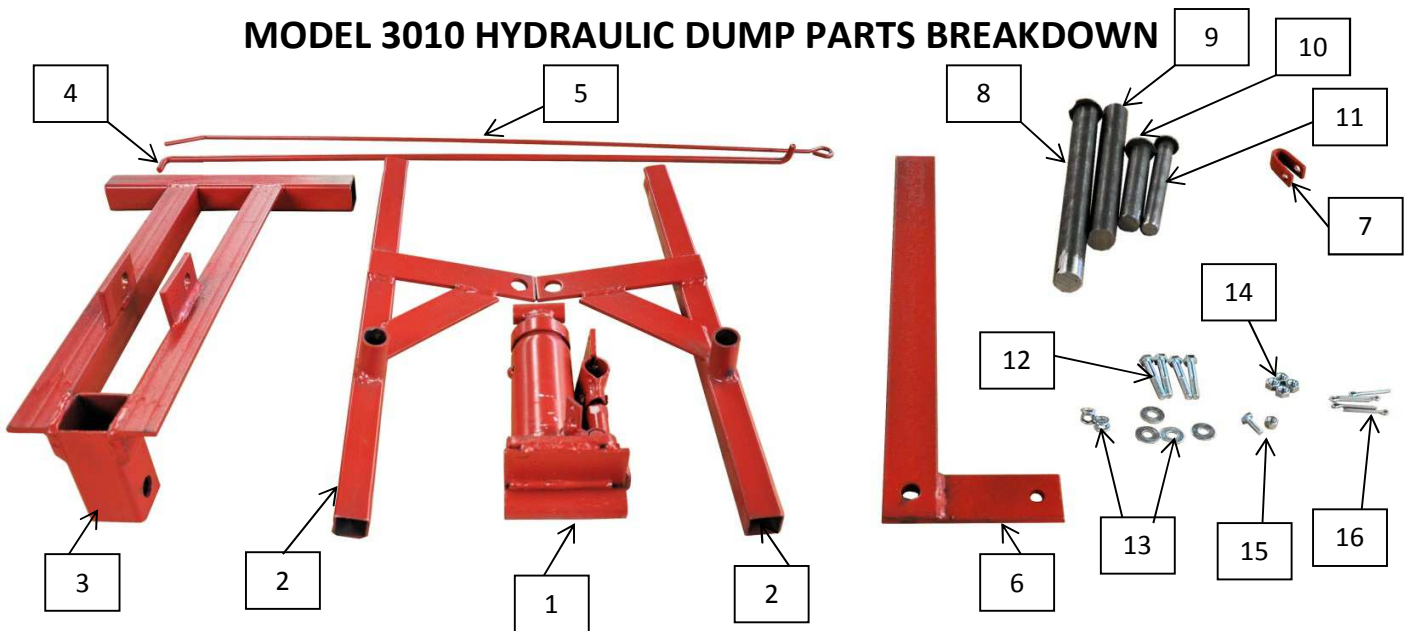

ITEM NO.	DESCRIPTION	QUANTITY
1	HYDRAULIC JACK	1
2	JACK FRAME	2
3	LIFT SLIDER	1
4	CONNECTING ROD	1
5	VALVE HANDLE	1
6	PUMP HANDLE	1
7	"U" CLIP	1
8	3/4" x 7-1/2" PIN (WASHER ON END)	1
9	3/4" x 6" PIN	1
10	5/8" x 3-1/4" PIN (WASHER ON END)	1
11	1/2" x 3-5/8" PIN (WASHER ON END)	1
12	5/16" x 2" BOLT	4
13	5/16" LOCK WASHER & FLAT WASHER	4 EACH
14	5/16" HEX NUT	4
15	1/4" x 3/4" BOLT & 1/4" HEX NUT	1 EACH
16	1/8" x 1-1/4" COTTER PIN	5



Country Manufacturing, Inc.

P.O. Box 104

Fredericktown, OH 43019

PH: 740-694-9926

FAX: 740-694-5088