

TOOLS REQUIRED

- 7/16" WRENCH AND SOCKET
- 9/16" WRENCH AND SOCKET
- PLIERS

SAFETY INSTRUCTION

DO NOT CARRY PASSENGERS IN CART.
 DO NOT TOW CART ON PUBLIC ROADS.
 NEVER EXCEED LOAD CAPACITY - 1000LBS.
 AVOID SUDDEN TURNS OR MANEUVERS.
 WHEN OPERATING ON SLOPES, USE LOWEST
 GROUND SPEED AND LIMIT LOAD TO 200LBS.
 OPERATE UP AND DOWN SLOPES, NEVER
 ACROSS THE FACE.

MAINTENANCE

CHECK TIRE PRESSURE REGULARLY.
 PERIODICALLY CHECK ALL BOLTS.
 KEEP CART CLEAN TO PREVENT RUST.
 STORE INSIDE A CLEAN DRY AREA.

CARTON CONTENTS	
REF. NO.	QTY.
1	1
2	1
3	1
4	1
5	4
6	1
7	1
8	2
17	1
15	1
50	1
60	1

BOLT BAG CONTENTS	
REF. NO.	QTY.
13	2
14	2
15	2
17	21
18	21
30	1
31	1

STEP 1.

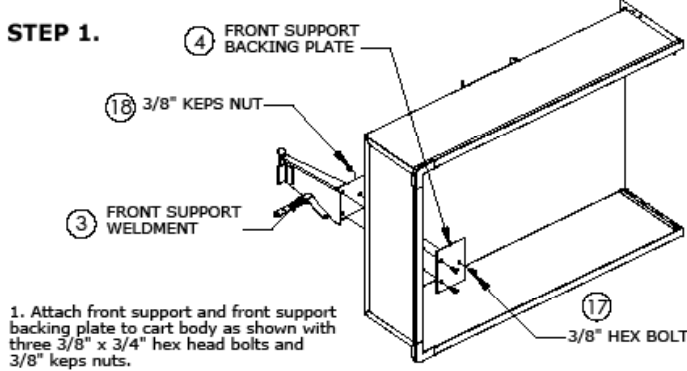

1. Attach front support and front support backing plate to cart body as shown with three 3/8" x 3/4" hex head bolts and 3/8" keps nuts.

STEP 2.

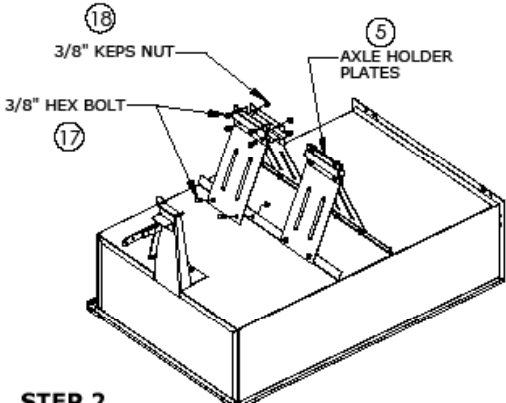

2. Loosely attach the four axle holder plates with the 3/8" x 3/4" hex head bolts provided. NOTE: these bolts will be tightened after axle and wheels are installed in a later step.

STEP 3.

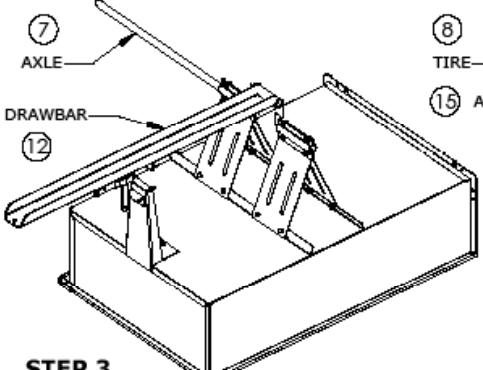

3. Center drawbar tube between axle holder plates and insert axle, making sure to center axle so that wheels can be put on in the next step.

STEP 4.

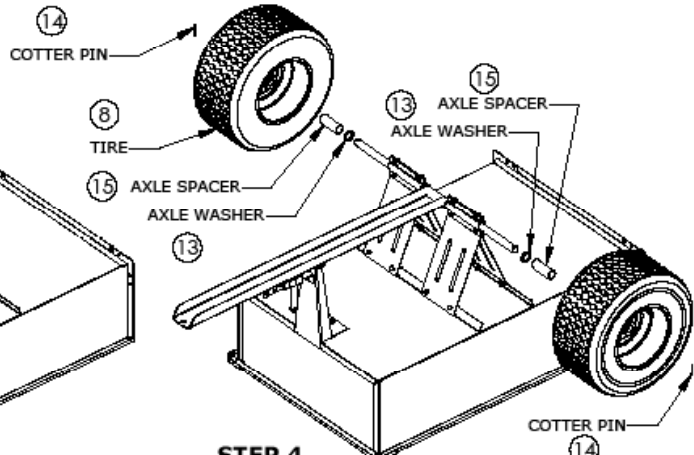

4. Slide axle washer and axle spacer over each side of axle as shown. Add wheels making sure valve stem faces out. Insert cotter pin in axle and lock in place by spreading ends. Turn cart upright and add tailgate.

5. Refer to repair parts list below. Attach hitch bracket to drawbar with two 3/8" x 3/4" hex bolts and keps nuts as shown. Insert hitch pin and lock in place with hairpin provided.

REPAIR PARTS LIST

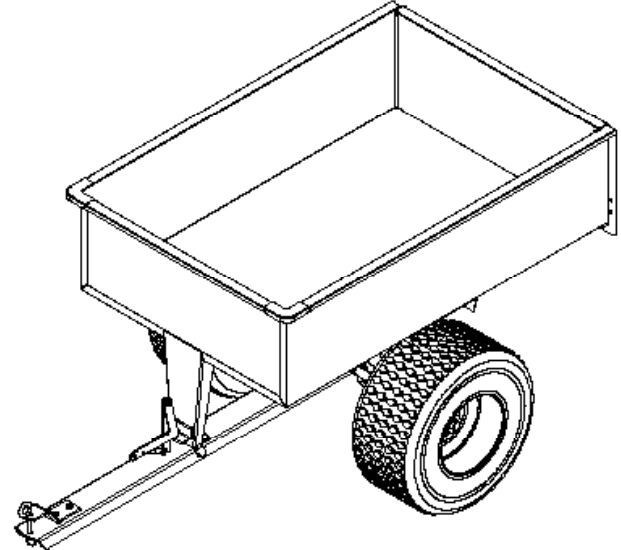
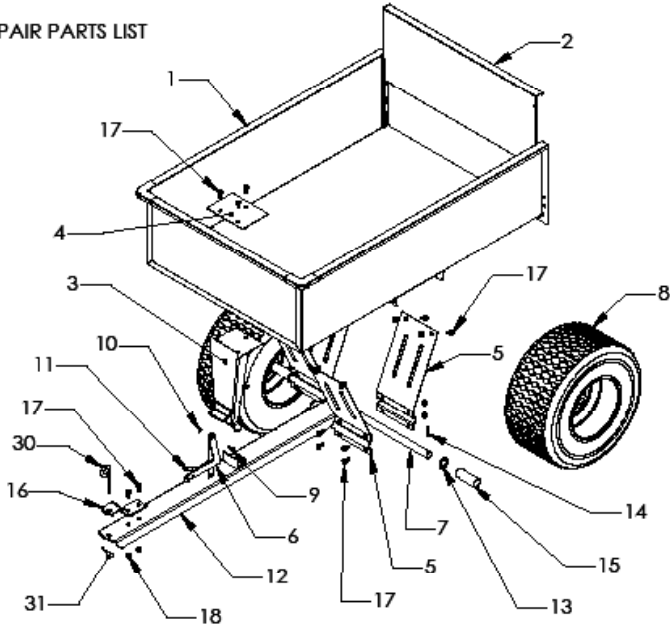

12 CU. FT. HEAPED CAPACITY
ALL TERRAIN CART
ASSEMBLY MANUAL AND PARTS LIST

REF. NO.	PART NO.	QTY.	DESCRIPTION	REF. NO.	PART NO.	QTY.	DESCRIPTION
1	3045HATV-1	1	CART BODY	13	3048HATV-13	2	NUT 3/8" X 3/4" HEX
2	3045HATV-2	1	TAILGATE	14	3048HATV-14	2	WASHER 1/2" X 1" X 1/2"
3	3045HATV-3	1	FRONT SUPPORT	15	3048HATV-15	2	AXLE BRACKET 3/8" DIA
4	3045HATV-4	1	FRONT SUPPORT PLATE	16	3048HATV-16	1	ATV HITCH BRACKET
5	3045HATV-5	1	AXLE HOLDER PLATE	17	3048HATV-17	2	BOLT 3/8" X 3/4" HEX
6	3045HATV-6	1	LATCH ARM	18	3048HATV-18	2	NUT 3/8" X 3/4" HEX
7	3045HATV-7	1	AXLE 1" DIA.	19	3048HATV-19	1	HITCH PIN 1/2"
8	3045HATV-8	1	ATV TIRE	20	3048HATV-20	1	HAIR PIN COTTER #7
9	3045HATV-9	1	BOLT 1/2" X 3/4" HEX	AM	3048HATV-AM	1	ASSEMBLY MANUAL
10	3045HATV-10	1	COTTER PIN	BB	3048HATV-BB	1	HARDWARE BAG
11	3045HATV-11	1	LATCH SPRING				
12	3045HATV-12	1	DRAWBAR				

* denotes standard hardware item, can be purchased locally.

CAUTION:
READ AND FOLLOW
ALL SAFETY RULES
AND INSTRUCTIONS
BEFORE USING
THIS EQUIPMENT.

Distributed By
Country Manufacturing, Inc.
www.countrymanufacturing.com
1-800-335-1880